

RANGE 7

OXFORD TWP.

TOWNSHIP 9

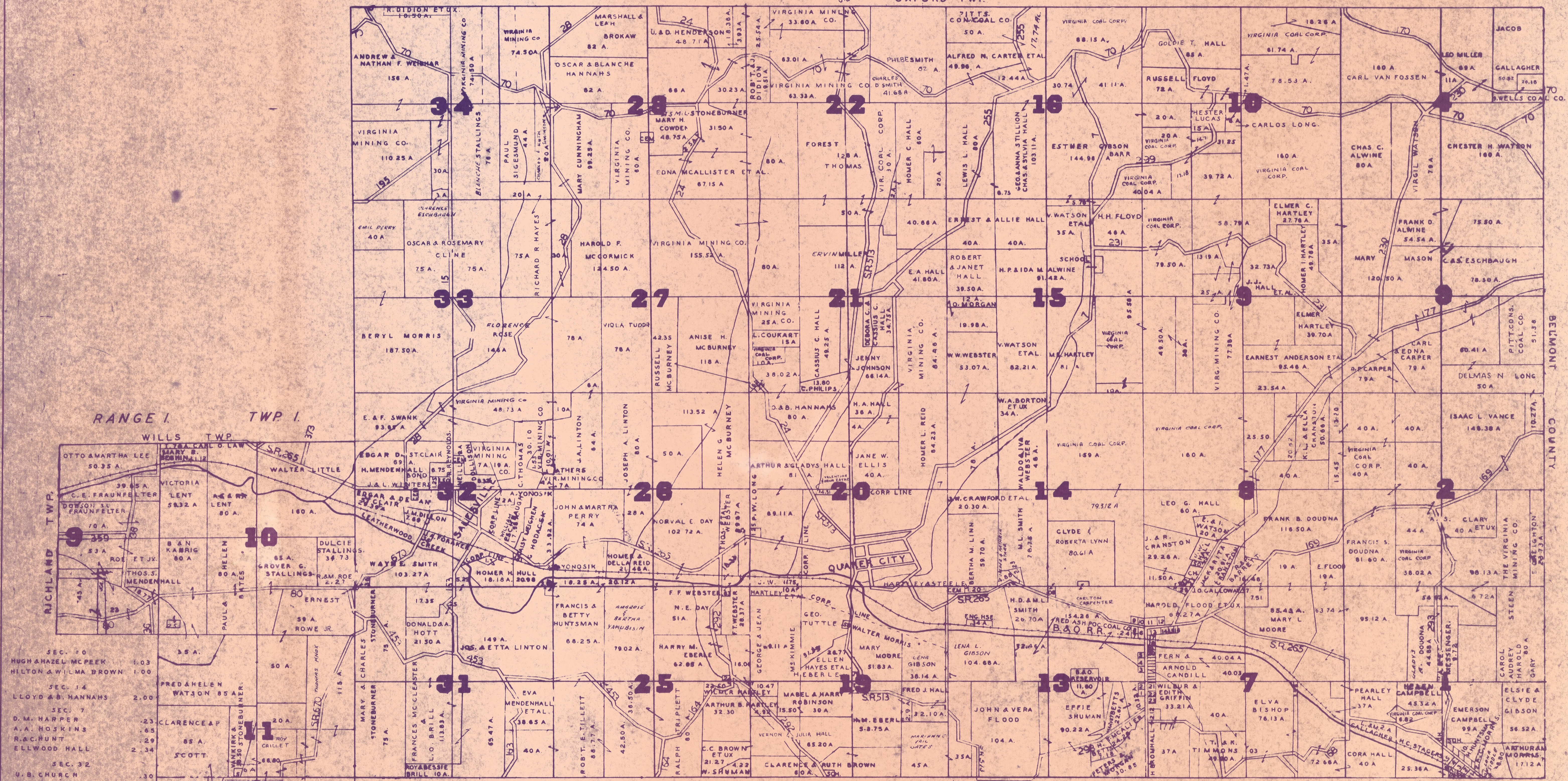

SEC. 10
HUGH & HAZEL MCPEEK 1.03
HILTON & WILMA BROWN 1.00

SEC. 14
LLOYD & HANNAH 2.00

SEC. 7
D.M. HARPER 2.3
A.A. HOSKINS 6.5
R. C. HUNT 2.39
ELLWOOD HALL 2.34

SEC. 32
U. S. CHURCH .30
MIKE YANOSIK 1.10
VA. MINING CO. 2.00
WM. ESCHBAUGH ET AL. 4.00
DEAN & O. S. ST. CLAIR 1.00
THE OHIO FUEL GAS CO. .64

MILL WOOD

SPENCER STA. SEC. 7 & 13

1	DONALD & SIMERAL	4.9
2	C. L. PHILIPS	3.8
3	C. A. R. WINTERS	3.8
4	RED ASH PROCO. CO.	3.1
5	W. A. ANDERSON	3.8
6	W. M. A. ANDERSON	3.8
7	CHAS. & L. HALL	1.0
8	ELLEN BLIDENBACH	9.5
9	CO. COMMISSIONERS	2.9
10	HOWARD BROMHALL	1.0
11	CENTRAL OHIO R. R. CO.	2.0
12	RAYMOND & C. HALL	5.0
13	RAYMOND & C. HALL	5.0
14	CORA CARPENTER	4.2
15	ENUCHE H. PEKARI	1.0
16	GOLDA TRIPLETT	1.0
17	HARRY J. BRODMHALL	1.0
18	HARRY J. CARPENTER	2.7
19	R. C. COWGILL	2.5
20	R. C. COWGILL	2.5
21	CLYDE LYNN ET AL.	1.0
22	CLYDE LYNN ET AL.	1.0
23	GEORGE CLARY	1.0
24	REDSH LUCAS	1.0
25	LESLIE LUCAS	1.0
26	LESLIE LUCAS	1.0
27	LESLIE LUCAS	1.0
28	LESLIE LUCAS	1.0
29	LESLIE LUCAS	1.0
30	LESLIE LUCAS	1.0
31	LESLIE LUCAS	1.0
32	LESLIE LUCAS	1.0
33	LESLIE LUCAS	1.0
34	LESLIE LUCAS	1.0
35	LESLIE LUCAS	1.0
36	LESLIE LUCAS	1.0

BAILEYS MILLS SEC. 1

NO	THOS TILLET	AC
1	RACHEL LASHLEY	2.7
2	JAS. THOMPSON	3.3
3	MARGARET WINTERS	5.0
4	...	2.5
5	...	2.5
6	NANCY & ELLEN CLARY	2.2
7	MARY LONG	8.8
8	GOLDIE HALEY	1.25
9	LEWIS KNOX	.42
10	EAL LONG	1.0
11	J. McLAUGHLIN	.54