

SHEET NO.
RANGE—TWP.—SEC. SUB. SHT.

06-00439 TOWNSHIP

CARD No.

REMARKS

3 2 Lot 42

CAMBRIDGE CORP.

LOT OR PARCEL NO.

CORPORATION OR VILLAGE

SUBDIVISION

98
X

MORTONS 42

CHESTNUT ST.

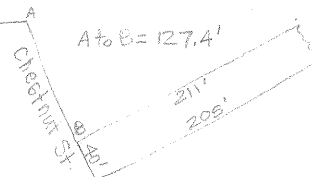

A to B = 127.4'

LET. A LET. B LET. C LET. D LET. E LET. F

.19

GRANTEE

ARNOLD, JOSEPHINE
WARDEN, FRANK from Auditor

TRANS. DATE VOL. PAGE

7-2-68 162 111
278 580

WARDEN, FRANK E. & BASIL

10/16/81 347 192

ANKROM, PATRICIA J. ETAL

11/30/81 347 349

SPLIT DATA

LET. TRANS. DATE VOL. PAGE SPLIT NO.

(OVER)