

SHEET NO.
RANGE--TWP.--SEC. SUB. SHT.

18-00477

TOWNSHIP

CARD No.

REMARKS

LIBERTY TWP.

W/S Split - 10.68 (398)

C.Pt. Lot #10

*Split .233 from 278
with chg by W/S
to 567
Split
90-000
noted*

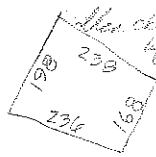

3 3 S1

LOT OR PARCEL NO.

CORPORATION OR VILLAGE

SUBDIVISION

10 10.7

NORTH ROAD ESTATES

LET. A	LET. B	LET. C	LET. D	LET. E	LET. F
1.00					

GRANTEE

TRANS. DATE VOL. PAGE

LET. TRANS. DATE VOL. PAGE SPLIT NO.

MILLER, CLARENCE R. & AGNES G?

BRICKER, ROBERT D.

2-3-71 289 567

DURBEN, GLENN E. & HELEN M.

4-12-79 334 220

DURBEN, HELEN M.

11-1-94 95 750

DURBEN, RICKY

4-17-95 104 938

SPLIT DATA

(OVER)