

A-1 SECRETARIAL SERVICES

115 West 8th Street
Cambridge, Ohio 43725

PHONE
614-432-4027

General Typing

Stenographic Services
Newsletters - Direct Mail

Shirley M. Wimer
Owner - Manager

T.3N.-R.2W.

JEFFERSON



Mrs. R. R. EUGENE & BETTY M.

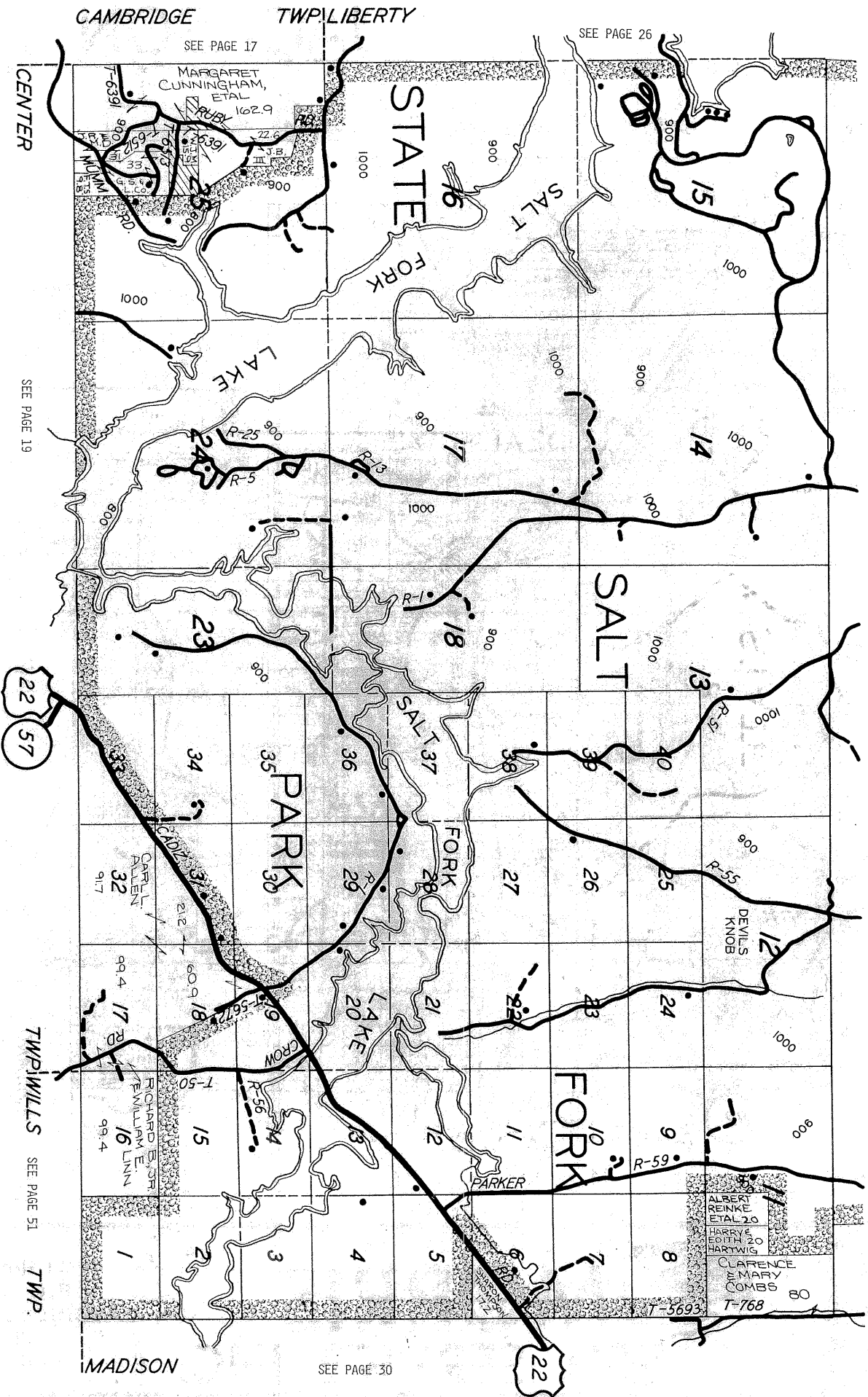
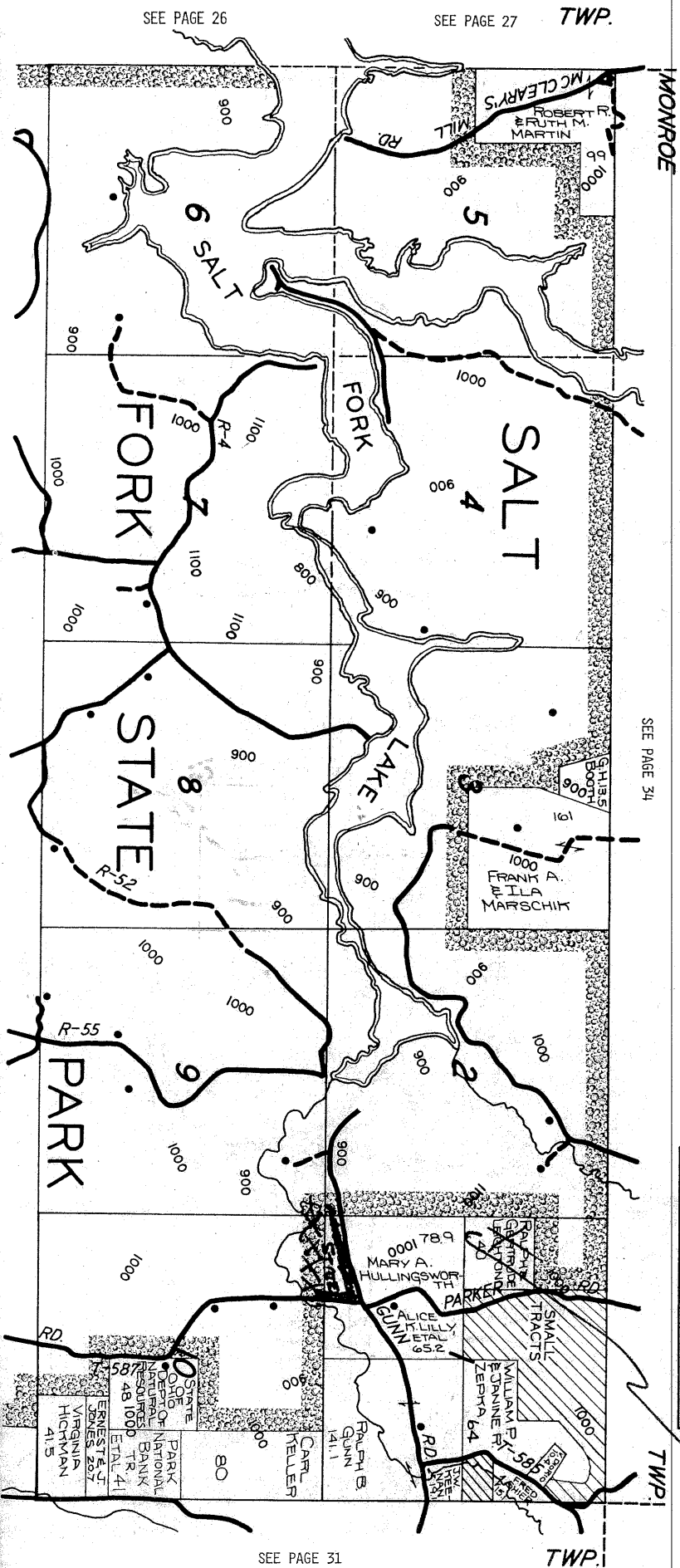

Town & Country Publishing Co., Inc.

ADVERTISING & MAP SERVICE

We are a major supplier of plat books for the midwest area. Our publications also include a separate division of city and county maps for advertising, distribution as well as enlarged reproductions of township maps. For further information, please contact Town & Country.

P.O. BOX 689 • LA PORTE, IN 46350 • PHONE (219) 362-8508