

# FAIRS ADDITION TO QUAKER CITY

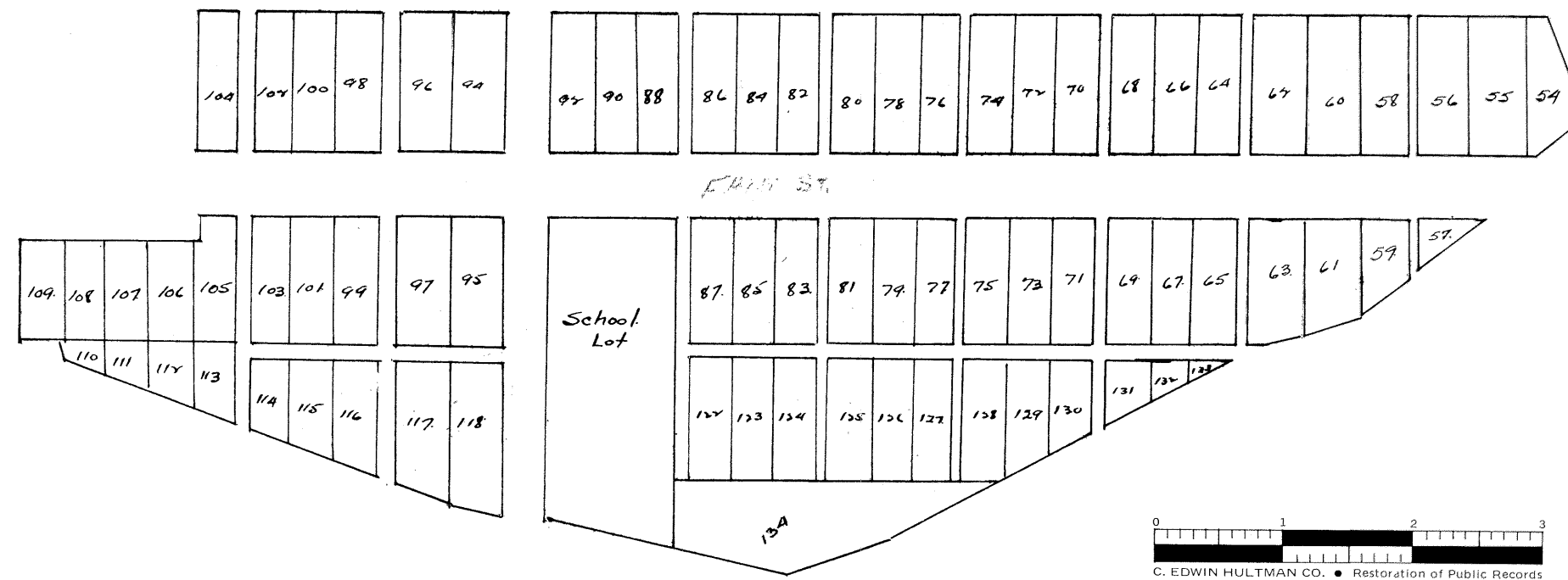

The description of the several lots of the Fair Addition to Quaker City. Known as a part of the S.E. quarter of Sec. 20 Range 7 Twp 9 Que. Co., O. beginning at the S.E. cor. of Cochran's Addition to Quaker City. with fractional lot No. 54. runs S 81° W 2 rods 14 lins to a point thence S 9° E. 8 rods 16 lins to a point. thence N 81° E. 2 rods to a corner. thence N 40° E. 3 rods 23 lins to a corner. thence N 31 1/4° W to the beginning containing 25.79 rods more or less. lot No. 55 begins at the NW cor. of fractional lot No. 54. & is 8 rods 16 lins long 2 rods 17 1/2 lins wide containing 23.32 rods more or less. lot No. 56 is 8 rods 16 lins long 2 rods 17 1/2 lins wide, lays west of lot 55 contains 23.32 rods more or less. fractional lot No. 57 begins at a corner. S 9° E. 4 rods from the SW cor. of lot 56 & runs S 9° E. 2 rods 6 lins to a cor. thence N 40° E. 3 rods 15 lins to a corner. thence S 81° W. 2 rods 14 lins to beginning containing 30.4 rods more or less. lot No. 58 begins at a corner. 16 ft south 81° W from the NW cor. of lot 56. is 8 rods 16 lins long. 2 rods 17 1/2 lins wide & contains 23.32 rods more or less. fractional lot No. 59 begins 16 ft. S 81° W. from the NW cor. of fractional lot No. 57. & runs S 81° W 2 rods 17 1/2 lins to cor. thence S 9° E. 4 rods 17 lins to cor. thence N 40° E. 3 rods 18 lins to cor. thence N 9° E. 3 rods 4 lins to beginning containing 11.8 rods. lot No. 60 is west of lot 58. 8 rods 16 lins long 2 rods 17 1/2 lins wide contains 23.32 rods. fractional lot No. 61 begins at NW cor. of 59. runs S 81° W 2 rods 17 1/2 lins. to cor. S 9° E. 7 rods 5 lins to cor. N 56° E. 3 rods to cor. N 9° W. 5 rods 17 lins to beginning containing 16.71 rods. lot No. 62 is west of lot No. 60 is 8 rods 16 lins long 2 rods 17 1/2 wide contains 23.32 rods fractional lot No. 63 begins at the NW cor. of lot 61 S 81° W 2 rods 17 1/2 lins to cor. - S 9° E. 8 rods to cor. N 81° E. 1 rod 3 lins to cor. N 56° E. 1 rod 24 lins to cor. N 9° W 7 rods 5 lins to beginning contains 20.34 rods. lot No. 64 lies 16 ft S 81° W from lot 62. 8 rods 16 lins long 2 rods 17 1/2 lins wide contains 23.32 rods. lot No. 65 lies 16 ft. S 81° W from fractional lot 63. & is 8 rods long 2 rods 17 1/2 lins wide contains 21.60 rods. lot No. 66 is west of lot 64. is 8 rods 16 lins long & 2 rods 17 1/2 lins wide contains 23.32 rods. lot No. 67 lies west of lot 65 8 rods long 2 rods 17 1/2 lins wide contains 21.60 rods lot No. 68 lies west of 66 and is the same size, lot No. 69 lies west of 67 & is the same size lot No. 70 is 16 ft S 81° W from lot No. 68 & is the same size. lot No. 71 is 16 ft S 81° W from lot 69 & is the same size. lot No. 72 is west from 70 & is the same size lot No. 73 is west from 71 & is the same size lot No. 74 is west from 72 & is the same size. lot No. 75 is west from 73. & is the same size, lot No. 76 is 16 ft S 81° W from lot 74 & is same size lot No. 77 is 16 ft S 81° W from lot No. 75 & is same size lot No. 78 is west from 76. is the same size lot No. 79 is west from 77 & is the same size. lot No. 80 is west from 78 & is the same size lot No. 81 is west from 79 & is same size lot No. 82 is 16 ft S 81° W from 80 & same size. lot No. 83 is 16 ft. S 81° W from 81. same size lot No. 84 is west from 82 & is same size lot No. 85 is west from 83 & is same size. lot No. 86 is west from lot 84 same size. lot No. 87 is west from 85 same size lot No. 88. is 16 ft S 81° W from 86 & is same size lot No. 89-91-93-119-120-121 and a part of 134. is Quaker City School lot. it begins 16 ft S 81° W from the NW cor. of 87. & runs S 81° W 8 rods 2 1/2 lins to cor. of Fair & south. Sts. S 9° E. 18 rods 23 lins to cor. S 83 1/2° E. 8 rods 13 lins to cor. N 9° W 21 rods to beginning contains 153.57 rods. lot 90 is west of lot 88 same size lot No. 92 is west of 90 same size lot No. 94 begins at N.E. cor lot 96. & is same size lot No. 95 is east of lot No. 97 & is same size lot No. 96 begins at a cor N 81° E 16 ft from 98. runs S 9° E. 8 rods 16 lins to cor. N 81° E. 3 rods 11 lins. to cor. N 9° W. 8 rods 16 lins to cor thence S 81° W 3 rod 11 lins to beginning contains 24.34 rods. lot No. 97 begins. 66 ft S 9° E. from the S.E. cor. of 96 & runs S 81° W 3 rods 11 lins. to cor. thence S 8° E. 8 rods to cor. N 81° E. 3. ds 11 lins. to cor. thence N 9° W. 8 rods to beginning contains 27.20 rods. lot No. 98 is east of lot 100 & is the same size lot No. 99 is east a lot 101 & same size lot No. 100 is east of 102 & is the same lot No. 101 is east of 103 & is same size lot No. 102 begins at a point 16 ft. N 81 from fractional lot No. 104. S 9° E 8 rods 16 lins to