

This improvement has been declared a Limited Access Highway from Station 746+00 to Station 32+00, by action of the Director of Highways and recorded in Volume 2542, Page 33426 of the Director's Journal pursuant to law.

For Succeeding Centerline Survey, see Plat for GUE-40-5.84 Recorded in Book 11, Page 25 of The Guernsey County Plat Records.

CENTERLINE SURVEY PLAT

INTERSTATE ROUTE 70

GUE-70-0.00 GUERNSEY COUNTY

WESTLAND TOWNSHIP, T-1, R-4, SEC. 2

ADAMS TOWNSHIP, T-2, R-4, SEC. 21 & 22, U.S.M.L.

Received April 30 1965
 Recorded April 30 1965
 Book 11 Page 87
 Jenn W. Campbell
 County Recorder

82
 2 OHIO

MUSKINGUM COUNTY
 GUERNSEY COUNTY
 MUS-70-26.00 GUE-70-0.00

394
 427

3
 36

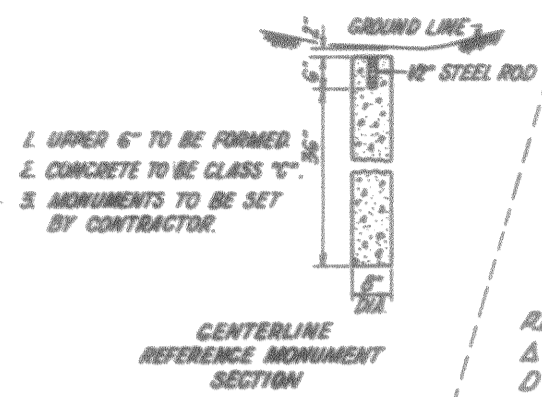

CHANNEL BASELINE
 CURVE DATA
 P.I. STA. 94+55.41
 $\Delta = 18^{\circ}35'00''$ LT.
 $D = 3^{\circ}00'$
 $R = 1902.06'$
 $T = 262.47'$
 $L = 321.67'$
 $E = 17.95'$

CURVE DATA - T.R. 444
 P.I. STA. 21+59.93
 $\Delta = 15^{\circ}50'47''$ RT.
 $D = 10^{\circ}00'00''$
 $R = 572.96'$
 $T = 79.74'$
 $L = 158.46'$
 $E = 5.52'$

CURVE DATA - T.R. 444
 P.I. STA. 29+36.94
 $\Delta = 41^{\circ}05'14''$ RT.
 $D = 10^{\circ}00'00''$
 $R = 572.96'$
 $T = 214.72'$
 $L = 410.87'$
 $E = 58.91'$

CURVE DATA
 P.I. STA. 1015+80.22
 $\Delta = 10^{\circ}12'00''$ RT.
 $D = 1^{\circ}00'$
 $R = 5729.50'$
 $T = 917.73'$
 $L = 1020.00'$
 $E = 73.03'$

CURVE DATA
 P.I. STA. 976+96.53
 $\Delta = 45^{\circ}51'00''$ RT.
 $D = 1^{\circ}20'$
 $R = 5906.53'$
 $T = 1652.19'$
 $L = 3126.16'$
 $E = 335.02'$

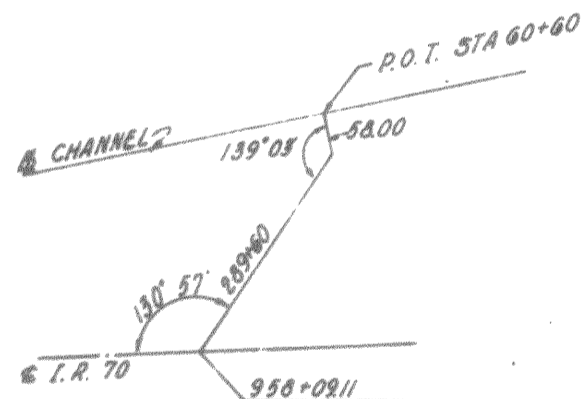
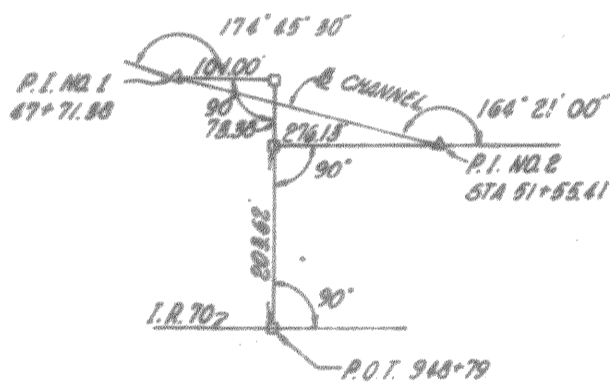

REFERENCE FROM CONSTRUCTION PLANS SEE SHEET NO. FOR CHANNEL RELOCATION

REFERENCE CENTERLINE	MONUMENTS I.R. - 70	MONUMENT ASSEMBLIES STATION	ASSEMBLY
RT. 751+07.25	920+00	RC. 11 + 98.02	C.H. 19
ROT. 755+00	925+00	R.O.C. 15 + 80	"
760+00	930+00	RT. 15 + 62.13	"
765+00	935+00	ROT. 21 + 00	"
770+00	RT. 941 + 45.27	ROT. 27 + 00	"
775+00	ROT. 945 + 00	RC. 29 + 47.51	"
780+00	850+00	RT. 31 + 59.42	"
785+00	955+00	RC. 78 + 39.70	C.H. 195
790+00	RC. 960 + 44.34	RT. 21 + 89.02	"
795+00	R.O.C. 965 + 00	RC. 26 + 97.94	"
RC. 797 + 81.44	970+00	ROT. 29 + 00	"
R.O.C. 802+00	975+00	RT. 31 + 29.33	"
807+00	980+00	ROT. 10 + 50	C.H. 450
812+00	985+00	ROT. 15 + 50	"
817+00	RT. 991 + 70.48	RC. 20 + 68.18	"
RT. 820 + 23.44	ROT. 995 + 00	RT. 25 + 80.92	"
ROT. 825+00	RC. 1000 + 32.49	ROT. 15 + 00	T.R. 444
830+00	ROT. 1005 + 00	RC. 20 + 80.19	"
840+00	R.O.C. 1010 + 00	RT. 22 + 38.65	"
845+00	1015+00	RC. 27 + 22.22	"
850+00	RT. 1024 + 82.49	RT. 31 + 33.09	"
855+00	ROT. 1030 + 00	"	"
RC. 860 + 74.30	1035+00	"	"
R.O.C. 865+00	1040+00	"	"
870+00	1045+00	"	"
875+00	1050+00	"	"
880+00	1055+00	"	"
885+00	1060+00	"	"
RT. 889 + 70.44	32+00	"	"
ROT. 895+00	"	"	"
900+00	"	"	"
905+00	"	"	"
RC. 909 + 00.03	"	"	"
R.O.C. 919 + 00	"	"	"
TOTAL 65		TOTAL	21

C. EDWIN HULTMAN CO. • Restoration of Public Records

I hereby certify that this is a true delineation of a survey made for the Ohio Department of Highways in 1963 by RACKOFF ASSOCIATES.
 David S. Guthrie
 Date Feb. 10, 1965
 Registered Surveyor No. 4370

END ACQUISITION
 MUS. 70-26.00
 GUE 70-0.00
 STA. 29+42.15

END PROJECT
 MUS 70-26.00
 GUE 70-0.00
 STA 32+00.00

Signed James T. Holden
 JAMES T. HOLDEN
 Date Feb. 10, 1965 Division Deputy Director

COMPLETION DATE FEB. 10, 1965	
REV. DATE	DESCRIPTION

R/W CENTERLINE SURVEY PLAT