

2 OHIO
COUNTY RECORDS
GUERNSEY COUNTY

CENTER LINE SURVEY PLAT

GUE-77-4.77

JACKSON & CAMBRIDGE TWPS.

U.S.M.L. N^o 4 & 5, SEC. N^os 6 & 15, T.1, R.2, U.S.M.L.

U.S.M.L. N^os 1, 2, 3, & 4, T.1, R.3, U.S.M.L.

GUERNSEY COUNTY



LIMITED ACCESS

I certify that the shaded area of this plan has been constructed according to the approved plan specifications.
Date May 6 19 76
Edward Hillman
District Deputy Director

59956
Received MAR. 23, 1978 Time 3:15 P.M.
Recorded MAR. 23, 1978
Plat Book 13 Page 12
Signed B. J. Hume, Jr. Recorder Guernsey Co. O.
Fee NONE Paid

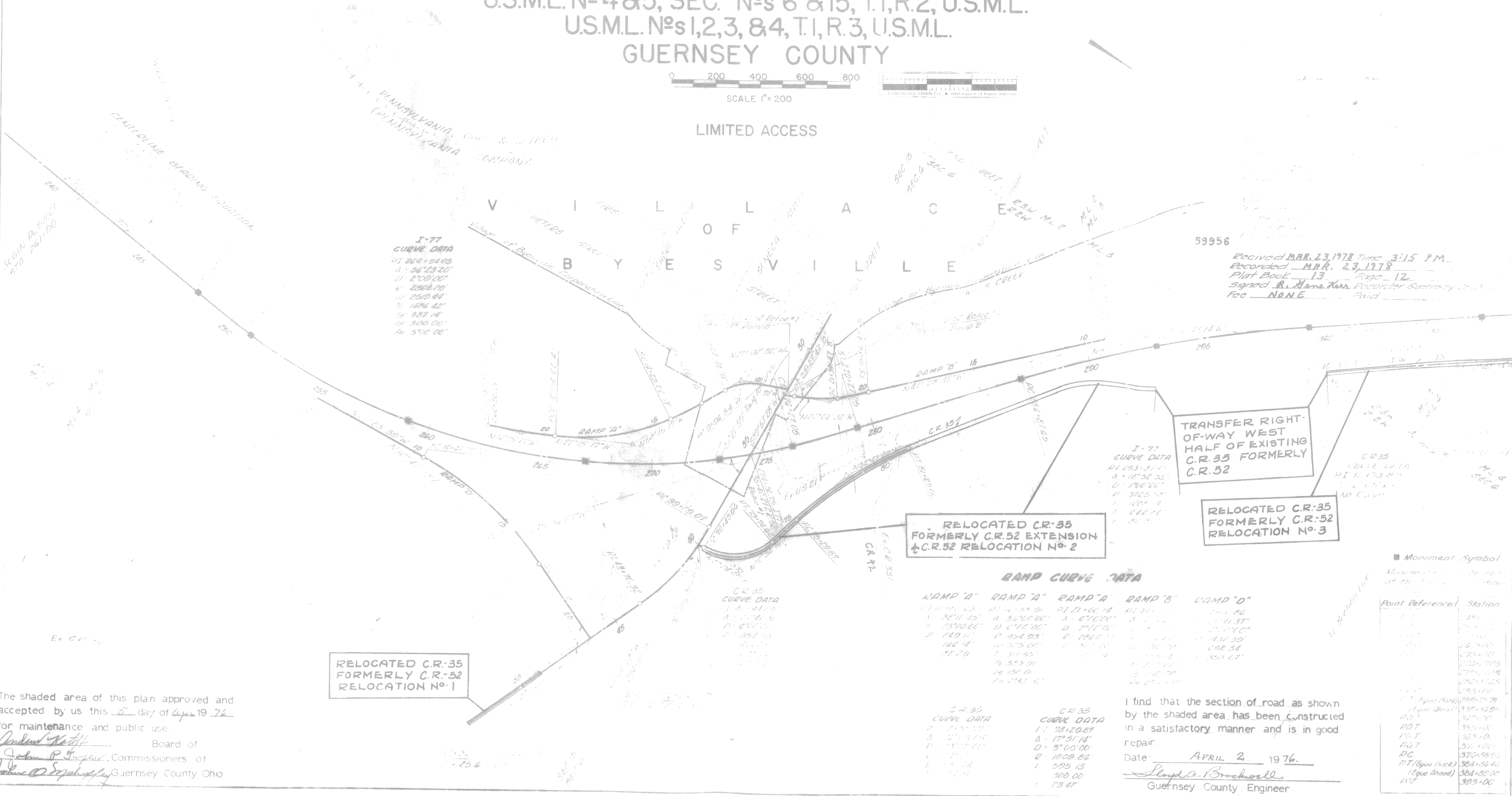

I-77 CURVE DATA
PI 268+04.03
A = 56°23'20"
D = 2700.00'
L = 2508.10'
E = 250.00'
T = 1486.42'
S = 387.14'
L = 300.00'
R = 320.00'

I-77 CURVE DATA
PI 293+37.15
A = 17°32'32"
D = 1800.00'
L = 5820.74'
E = 1227.11'
T = 686.66'
R = 30.00'

TRANSFER RIGHT-OF-WAY WEST HALF OF EXISTING C.R. 35 FORMERLY C.R. 52

RELOCATED C.R. 35 FORMERLY C.R. 52 EXTENSION & C.R. 52 RELOCATION N^o 2

RELOCATED C.R. 35 FORMERLY C.R. 52 RELOCATION N^o 3

RELOCATED C.R. 35 FORMERLY C.R. 52 RELOCATION N^o 1

RAMP CURVE DATA

RAMP "A"	RAMP "A"	RAMP "A"	RAMP "B"	RAMP "D"
PI 110+03	PI 16128+29	PI 21166+18	PI 21166+18	PI 21166+18
A = 85°18'05"	A = 32°45'00"	A = 67°00'00"	A = 67°00'00"	A = 67°00'00"
D = 2300.00'	D = 4700.00'	D = 2900.00'	D = 2900.00'	D = 2900.00'
L = 189.11'	L = 358.93'	L = 2066.19'	L = 2066.19'	L = 2066.19'
E = 186.14'	E = 358.93'	E = 186.14'	E = 186.14'	E = 186.14'
T = 87.20'	T = 358.93'	T = 87.20'	T = 87.20'	T = 87.20'
R = 353.91'	R = 353.91'	R = 353.91'	R = 353.91'	R = 353.91'
L = 151.00'	L = 151.00'	L = 151.00'	L = 151.00'	L = 151.00'
R = 243.00'	R = 243.00'	R = 243.00'	R = 243.00'	R = 243.00'

C.R. 35 CURVE DATA	C.R. 35 CURVE DATA
PI 110+03	PI 178+20.87
A = 85°18'05"	A = 17°51'18"
D = 2300.00'	D = 5°00'00"
L = 189.11'	L = 1008.86'
E = 186.14'	E = 595.13'
T = 87.20'	T = 300.00'
R = 353.91'	R = 23.81'

I find that the section of road as shown by the shaded area has been constructed in a satisfactory manner and is in good repair.
Date APRIL 2 19 76
Royd A. Bruchwell
Guernsey County Engineer

■ Monument Symbol

Monument placed by me at the following stations:

Point Reference	Station
1	181+00
2	181+00
3	181+00
4	181+00
5	181+00
6	181+00
7	181+00
8	181+00
9	181+00
10	181+00
11	181+00
12	181+00
13	181+00
14	181+00
15	181+00
16	181+00
17	181+00
18	181+00
19	181+00
20	181+00
21	181+00
22	181+00
23	181+00
24	181+00
25	181+00
26	181+00
27	181+00
28	181+00
29	181+00
30	181+00
31	181+00
32	181+00
33	181+00
34	181+00
35	181+00
36	181+00
37	181+00
38	181+00
39	181+00
40	181+00
41	181+00
42	181+00
43	181+00
44	181+00
45	181+00
46	181+00
47	181+00
48	181+00
49	181+00
50	181+00

The shaded area of this plan approved and accepted by us this 4 day of April 19 76 for maintenance and public use.
Robert H. Hitt Board of Commissioners of Guernsey County Ohio
John P. Taylor
John O. England