

# CENTERLINE SURVEY PLAT

## GUE-340-175

GUERNSEY COUNTY, OHIO

VILLAGE OF CUMBERLAND, SECTIONS 32&33, TOWNSHIP 9N, RANGE 10W

**NOT TO SCALE**

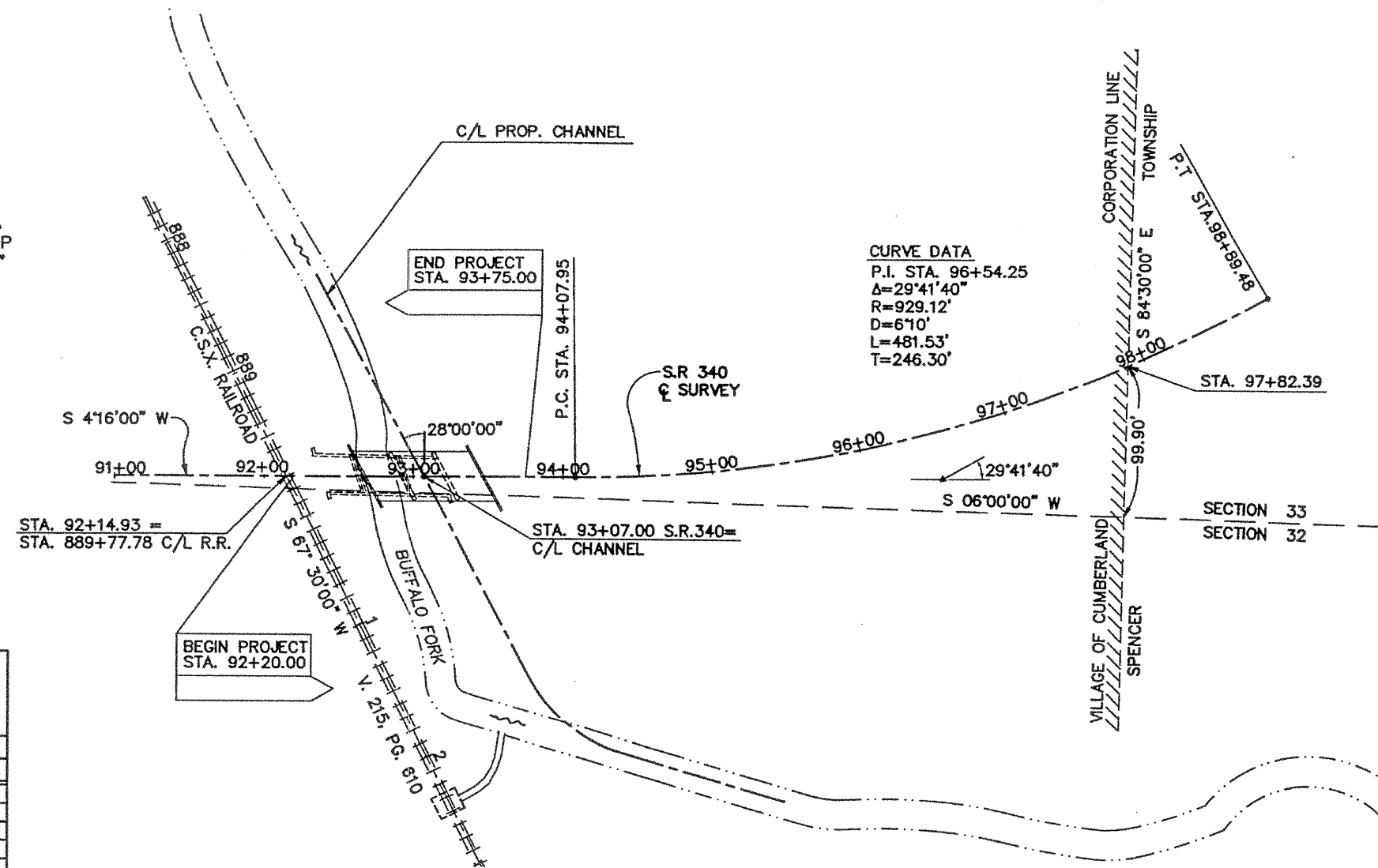
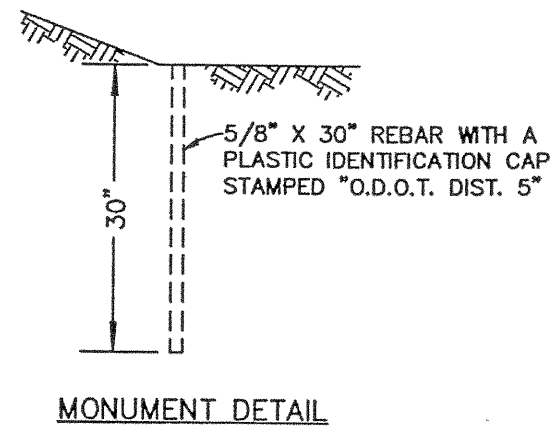

**CURVE DATA**  
 P.I. STA. 96+54.25  
 $\Delta = 29^{\circ}41'40''$   
 $R = 929.12'$   
 $D = 671.0'$   
 $L = 481.53'$   
 $T = 246.30'$

RIGHT OF WAY MONUMENTS ARE TO BE SET BEFORE CONSTRUCTION AT THE FOLLOWING STATIONS AT A TOLERANCE OF +/- 0.02 FT.

CENTERLINE REFERENCE MONUMENTS				604
LT.	STATION	RT.	LOCATION	EACH
30.00'	91+81.33	37.64'	P.O.T.	2
30.00'	94+07.95	44.49'	P.C.	2
TOTAL				4

NOTE: STATIONS AND OFFSETS ARE UPON CENTERLINE OF DESIGN. MONUMENTS SHALL BE INSTALLED BY STATE FORCES.

**BASIS FOR BEARINGS:**

BASIS OF BEARING CONTAINED IN RIGHT-OF-WAY PLANS FOR STATE PROJECT "S.H. 688, SEC. A, GUERNSEY COUNTY" DATED 1933 AND ON FILE WITH THE OHIO DEPARTMENT OF TRANSPORTATION.

I HEREBY CERTIFY THAT THIS PLAT IS A TRUE DELINEATION OF A SURVEY MADE FOR THE OHIO DEPARTMENT OF TRANSPORTATION IN 1993 BY CLYDE E. WILLIAMS & ASSOCIATES, INC.  
*Abdul Wadood A. Haidar* DATE 3-6-95  
 REGISTERED SURVEYOR NO.



RECEIVED 2/22 1996  
 RECORDED 19  
 BOOK CAB / 3 PAGE 450  
 COUNTY RECORDER

CENTERLINE SURVEY PLAT

GUE-340-1.75

1 / 4

26 / 29

FEDERAL PROJECT NO. BFR 93A (0)  
 STATE PROJECT NO. 053700

SCALE IN FEET  
 0 50 100

File Name: I:\281184\184002\1\CD01\AS-202\1\_032023P.DWG