

**BENCH MARK DESCRIPTIONS:**

- TP-4 - SPIKE, 1.4' ABOVE GROUND ON EAST SIDE OF T/P POLE O.P.C.O. 575-245 / 27901-2351 GTE. POLE IS  $\approx$  50' WEST OF E.R.R. ELEV. 790.61.
- TP-6 - CHISELED SQUARE ON TOP OF SE CORNER OF 5'x5' CONCRETE WALL AROUND HIGH WATER PUMP STATION AND  $\approx$  50' WEST OF E.R.R. ELEV. 787.24

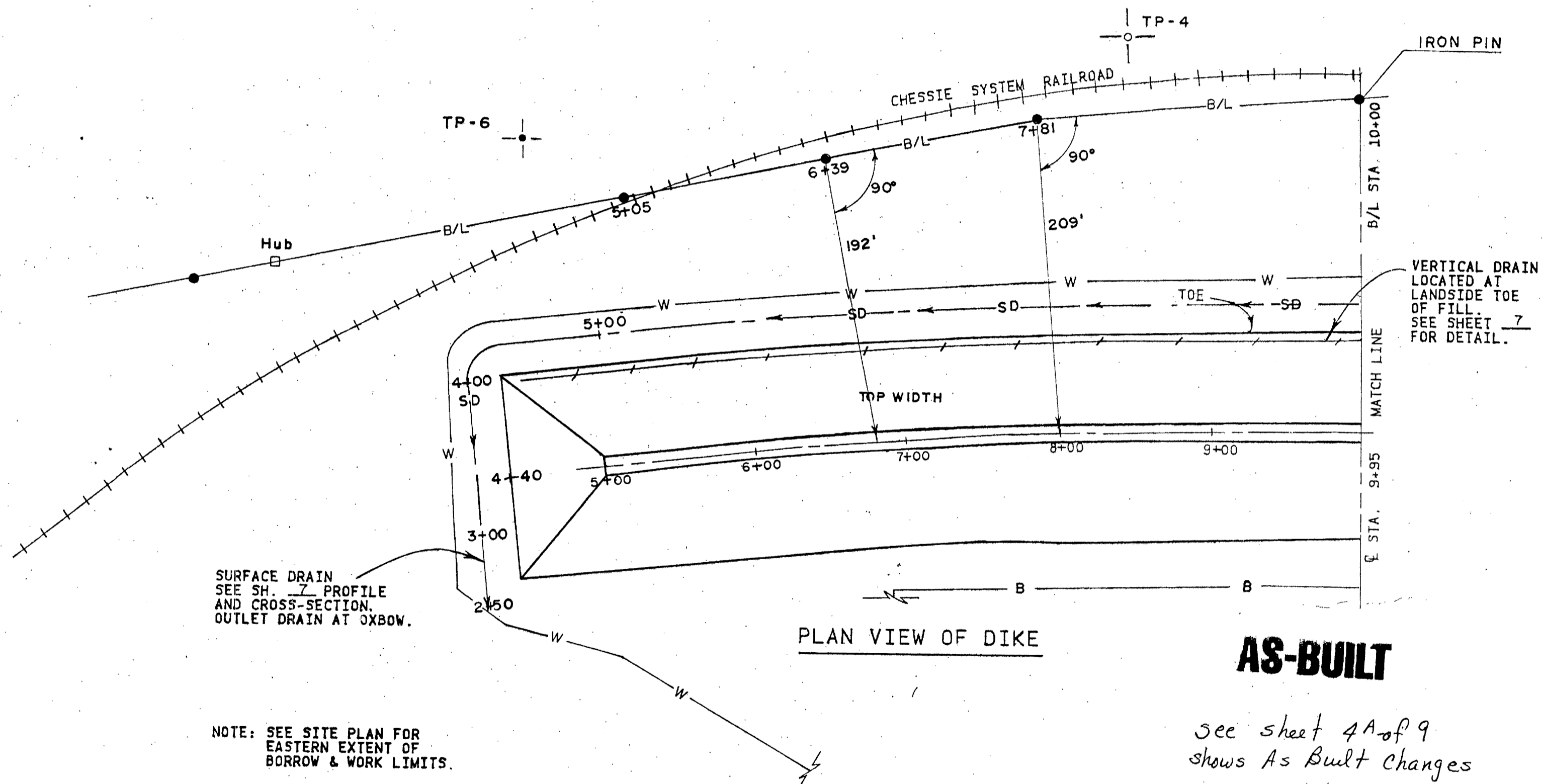

**LEGEND**

- WORK LIMITS..... W
- SURVEY BASELINE..... B/L
- E OF DIKE..... E
- SOIL BORING..... (X) :101
- CURVE RADIUS POINT..... (C) R11
- RAILROAD..... + + + + +
- BORROW AREA..... B
- SURFACE DRAIN..... SD
- VERTICAL DRAIN..... / / / / /

SURFACE DRAIN  
SEE SH. 7 PROFILE  
AND CROSS-SECTION.  
OUTLET DRAIN AT OXBOW.

NOTE: SEE SITE PLAN FOR  
EASTERN EXTENT OF  
BORROW & WORK LIMITS.

**PLAN VIEW OF DIKE**

**AS-BUILT**

see sheet 4A of 9  
shows As Built Changes  
11/11/92



PLAN VIEW OF DIKE-E 4+40 TO E 9+95  
SOUTHGATE DIKE, CITY OF CAMBRIDGE  
WILLS CREEK WATERSHED (PL-566)  
GUERNSEY CO., OHIO

**U. S. DEPARTMENT OF AGRICULTURE  
SOIL CONSERVATION SERVICE**

Designed R. S. YEOMAN	Date 3/90	Approved by	
Drawn C. W. MCGUIRE	Date 3/90	Title	
Traced		Sheet	Drawing No.
Checked T. L. RUCH	Date 6/90	No. 4	OH-870107
		of 9	