

BENCH MARK DESCRIPTIONS:

- TP-3 - SPIKE, 1.4' ABOVE GROUND ON NORTH SIDE OF P/T POLE O.P. CO 575-243 / 27901-2301 GTE. POLE IS ~ 27' WEST OF E.R.R. AND 2ND. POLE NORTH OF ANGLE POLE. ELEV. 788.70.
- TP-7 - SPIKE, 1.0' ABOVE GROUND ON EAST SIDE OF P/T POLE O.P. CO. 575-290. OF 84 LUMBER BUILDING. ELEV. 794.78

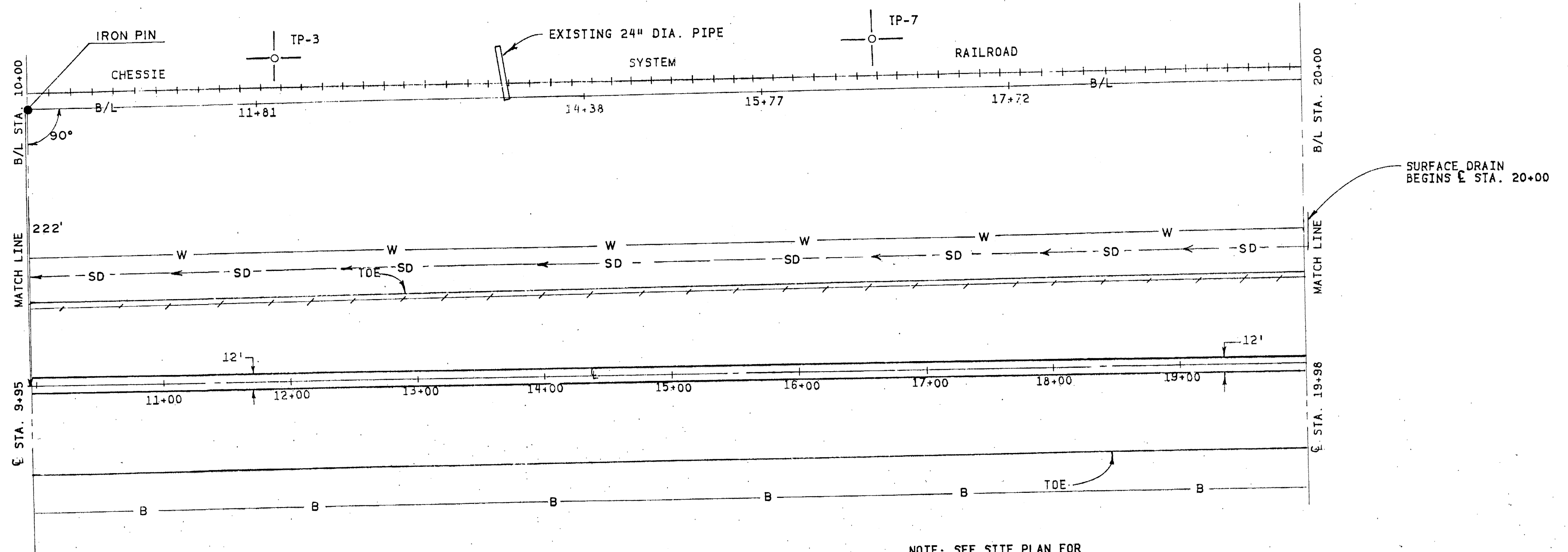

LEGEND

- WORK LIMITS..... W
- SURVEY BASELINE..... B/L
- E OF DIKE..... E
- SOIL BORING..... 101
- CURVE RADIUS POINT..... R_i
- RAILROAD.....
- BORROW AREA..... B
- SURFACE DRAIN..... SD
- VERTICAL DRAIN.....

PLAN VIEW OF DIKE

NOTE: SEE SITE PLAN FOR EASTERN EXTENT OF WORK AND BORROW LIMITS

AS-BUILT



*Replaced with sheet
5A of 9
For As Built Changes
11/1/92*

PLAN VIEW OF DIKE-E 9+95 TO E 19+98
SOUTHGATE DIKE, CITY OF CAMBRIDGE
WILLS CREEK WATERSHED (PL-566)
GUERNSEY CO., OHIO

**U. S. DEPARTMENT OF AGRICULTURE
SOIL CONSERVATION SERVICE**

Designed: R. S. WEDMAN	Date: 10/98	Approved by: _____
Drawn: C. W. MCGUIRE	Date: 10/88	Title: _____
Traced: _____	Sheet: _____	Drawing No: _____
Checked: T. L. RUCH	Date: 6/90	No. 5 of 9
		OH-870107