

SHEET NO.  
RANGE—TWP.—SEC. SUB. SHT.

Q4 06-00390 TOWNSHIP

CARD No.

REMARKS

PG40

3 2 L23 A317

CAMBRIDGE CITY CORP.

1240  
GOMBER

Pt. Lot #23

Gomber Ave

LOT OR PARCEL NO.

CORPORATION OR VILLAGE

SUBDIVISION

88

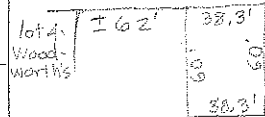

LET. A .053

LET. B

LET. C

LET. D

LET. E

LET. F

~~.06~~

SPLIKER 1978

GRANTEE

TRANS. DATE

VOL.

PAGE

LET.

TRANS. DATE

VOL.

PAGE

SPLIT NO.

DUGAN, EDNA M.

STEVENS, CHARLES W.

6-26-72

296

554

SHINN, ROBERT L. & BETTY S.

12-4-72

299

397

CLARK, RICHARD H. & SHIRLEY J.

4-28-78

329

95

GUERNSEY SAVINGS BANK

7/25/91

24

936

LEGGETT, TERRY & VICKI

7-25-91

34

598

LEGGETT, VICKI J

6-25-10

471

2106

GADD, PATRICK J

109-2013

508

1987

SPLIT DATA

(OVER)