

06-08882

3 2

CAMBRIDGE CORP.

453  
2nd S  
N. 2

No. 11 exception  
Pt.O.L.#5  
58' 3WD  
84' x 130' pc  
W side 2nd

LOT OR PARCEL NO.

CORPORATION OR VILLAGE

SUBDIVISION

12

OUTLOT LOFLAND 3

DEPUTY

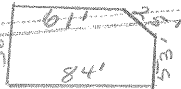

LET. A LET. B LET. C LET. D LET. E LET. F

.111

.139

GRANTEE

REED, BERNARD & VERA  
WHITE, MATTIE

WHITE, MATTIE & CONNIE L.

WHITE, CONNIE L.

WHITE, MATTIE R

BALDWIN, SONIA

TRANS. DATE VOL. PAGE

5-23-69 282 364

5-16-01 275 1018

9-10-08 459 495

1-5-2011 475 2106

1-5-2011 475 2104

(OVER)

SPLIT DATA

LET. TRANS. DATE VOL. PAGE SPLIT NO.

A 8/31/83 355 605 41

B 3-3-97 149 370 43