

SHEET NO.
RANGE-TWP.-SEC. SUB. SHT.

12-00848

TOWNSHIP

JACKSON TWP.

CARD No.
235
S 2ND ST

REMARKS PG12
N/S HUNNEL 96"
S.Pt. Lot #148

3 1 M2 A02-07-7

LOT OR PARCEL NO.

CORPORATION OR VILLAGE

SUBDIVISION

BYTES

148

BYESVILLE CORP.

WATSON

LET. A

LET. B

LET. C

LET. D

LET. E

LET. F

.039

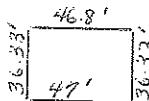

(Plat - All Lot #2)

GRANTEE

TRANS. DATE

VOL.

PAGE

PORTER, HILDA C.

LELAND, MARGARET

ANDERSON, WM. J.

YOUNG, JAMES M & PATRICIA

BARTHALOW AUTO WRECKING, INC.

MC ELROY, JAMES A. & LAVERNE L.

SILLS, THOMAS L. & LOUISE K.

SILLS, SCOTT A & RYAN L

SILLS, SCOTT A & CHRISTINE

8-8-79 336 109

8/27/79 336 463

12-17-84 361 130

5-17-88 377 10

4-29-96 129 52

10-7-96 140 294

1-8-2013 498 2453

6-7-2017 547 2327

SPLIT DATA

LET.

TRANS. DATE

VOL.

PAGE

SPLIT NO.

(OVER)