

23-00619

TOWNSHIP

7 9 S32

MILLWOOD TWP.

6028 No. 1000 HSE REMARKS SALESVILLE

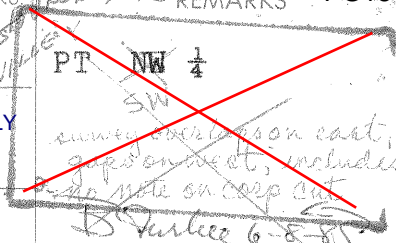

LOT OR PARCEL

CORPORATION OR VILLAGE

SUBDIVISION

SEE ALSO MAP# 18 & 99 FORMERLY SALESVILLE VILLAGE

54

LET. A 104.7 1.23	LET. B 103.47 1.509	LET. C 101.961 6.009	LET. D 95.952 5.006	LET. E 90.946 5.010	LET. F 85.936 5.141
-------------------------	---------------------------	----------------------------	---------------------------	---------------------------	---------------------------

CLAUS '92 18-15.1

GRANTEE	TRANS. DATE	VOL.	PAGE
LENT, CHARLES	6-4-68	273	174
LENT, CHARLES C. & FLORENCE M.	6-8-88	377	275
DEIWEILER, J.J. ENTERPRISES, INC.	8-4-92	46	312
MILL STREET ROAD LAND TRUST	2-16-2016	534	2026

SPLIT DATA	LET.	TRANS. DATE	VOL.	PAGE	SPLIT NO.
	A	8-1-78	330	736	
B	9-23-86	369	194	69	
C	9-28-95	111	99	72	
D	9-28-95	111	99	71	
E	11-21-96	143	369	73	
F	12-20-96	145	223	74	
G	4-9-98	181	326	75	
H	1-8-99	205	686	76	
I	7-24-03	366	390	82	
J	7-7-04	403	207	83	
K	3-7-05	424	287	84	

SEE ATTACHED CARD

